

HILTON AMSTERDAM

THE FACTS



Set in the heart of one of Europe's most cosmopolitan cities, Hilton Amsterdam makes the perfect base for exploring all that the area has to offer. Just a short distance from the capital's most famous tourist attractions and main business districts, our contemporary hotel is the perfect venue for both business and pleasure. Wake up in a spacious and well-appointed guest room, enjoy attentive service and make the most of a wide range of on-site facilities, including a choice of dining options.

AT A GLANCE

- Located on the South Axis, commercial & business district
- Easily accessible by public transport and car
- Executive Floor and Executive Lounge
- High speed wireless internet throughout the hotel, complimentary in all public areas
- 3 restaurants and bars, and In-Room Dining available 24 hours, 7 days a week
- 21 versatile meeting rooms with a 500 person capacity Ballroom
- Fully-equipped Business Centre

OUR ROOMS

Total number of rooms: 271
Deluxe rooms: 175
Executive rooms: 61
Junior suites: 31
Mercurius suite: 1
Neptunus suite: 1
John & Yoko suite: 1
Presidential suite: 1
Check-in: 2:00pm
Check-out: noon

GUEST ROOMS

Featuring custom-made furniture and rich interiors designed by Nobilis Paris, our stylish guest rooms offer a peaceful and contemporary space decorated in dark wooden and golden tones. Smart, spacious and well equipped, our rooms offer a wide range of facilities designed to meet our Guests' needs:

- Individually controlled air conditioning
- High speed wireless internet, separate modem connection
- Cable TV and on-demand movies
- 2 telephones for internal and external calls
- Voicemail service
- Safety deposit box
- Mini-bar, coffee & tea making facilities
- Canal and garden views
- MP3 alarm radio
- Connecting guest rooms

The same amenities are available in our beautifully appointed suites, taking comfort and style to the next level. The John & Yoko suite, famous for its 1969 'Bed-in for Peace', provides a truly unique experience.



EAT & DRINK

ROBERTO'S

Prepare for the day ahead at Roberto's with Breakfast at Hilton, which includes an extensive selection of hot and cold items with local, regional and international options.

Also open for lunch and dinner, this Italian restaurant features an inviting décor that takes you back to the ambiance of the 60s. Choose from a fine selection of classic dishes, prepared using fresh seasonal ingredients. To accompany, pick a wine from the extensive list. Weather permitting, the heated terrace is the perfect location for al fresco dining in the summer.

ISSIMO

Savour fresh Italian pastries or enjoy a freshly squeezed juice. At lunchtime, this welcoming café also offers a selection of tasty hot or cold sandwiches. Run in cooperation with Illy, Italy's premium coffee manufacturer, Issimo is perfect for meeting up with friends and colleagues over an authentic Italian espresso. Take away and gourmet gifts are also available.

HALF MOON LOUNGE

This nautically themed lounge features a cosy fireplace and large windows with views over the canal and the marina. Perfect for drinks, snacks and light refreshments, this venue is popular with both locals and Guests alike.

GARDEN TERRACE

Soak up the sun in the Garden Terrace from midday until late in the evening with al fresco lunches and drinks.



OUT & ABOUT

Make the most of your stay at Hilton Amsterdam by exploring the many attractions on offer in the area. With wonderful architecture, an exciting atmosphere, and a rich and varied culture, Amsterdam has it all. The magnificent monuments, ancient canals and graceful bridges of the past combine with the modern-day cosmopolitan scene, making it one of Europe's most sophisticated cities.

Within walking distance of the hotel:

- Exclusive shopping areas: P.C. Hooft Street and the Apollo Quarter
- Rijksmuseum, Stedelijk Museum and Van Gogh Museum
- Royal Concert Hall
- Vondelpark
- Christie's Auction House
- Tennis courts
- Toomler: stand-up comedy and live jazz sessions

Short driving distance from the hotel:

- 18-hole golf course - 15km
- Beach - 24km

Hilton Amsterdam has various partnerships in order to ensure Guest satisfaction. Therefore, should a request be outside our expertise we will be able to work in partnership to arrange professionally organised events which cover every detail of your request, from invitations to transport and entertainment.

OUR FACILITIES

ON-SITE LEISURE FACILITIES

Hilton Amsterdam offers a range of facilities for relaxation or entertainment. Stay fit during your travels by exercising in the on-site health club or simply rent a bicycle to explore the city. Classic boat rentals are also available to enable you to get the full Amsterdam experience.

EXECUTIVE LOUNGE

Enjoy a complimentary breakfast, refreshing cocktails and a wide selection of drinks and snacks while admiring the stunning views over the city. An inviting and stylish place to work or relax, the Executive Lounge provides private Check-In and Check-Out services and is exclusively for Guests staying in our Executive rooms or suites.

LOCATION

Ideally situated in the city's most desirable district, Zuid, Hilton Amsterdam is easily accessible and centrally located. The hotel is just a 15-minute drive from Amsterdam Schiphol Airport and within a short walking distance of the old city centre.

HILTON AMSTERDAM
Apollolaan 138 | 1077 | BG | Amsterdam
The Netherlands

T: +31 (0)207 106 000
F: +31 (0)207 106 080
E: info.amsterdam@hilton.com

amsterdam.hilton.com



HERE ON BUSINESS

Choose from 21 flexible function rooms, all equipped with high speed wireless internet, individual air conditioning, ergonomic chairs and modern conference equipment. Our meeting facilities include:

- Ballroom with a capacity of up to 500 people
- 14 meeting rooms and 7 versatile boardrooms
- Telephone with a direct line to the Business Centre
- Webcasting facilities
- Built-in screens
- Stationery kits
- Mini-bar
- The Pavilion's unique meeting space

Whether planning a large conference or celebratory banquet, benefit from full technical support, the latest audiovisual technology, and an array of catering options and facilities, including an Executive Lounge.

In addition, our dedicated in-house Business Centre is equipped with three private workstations, each with a computer, high speed internet access, video conferencing facilities, audio equipment and colour printer. Secretarial services are also available.

Whatever the occasion, Hilton Amsterdam has the expertise and range of venues to bring your event to life.

THE PAVILION

Ideal for lunch, dinner, wedding receptions, cocktail parties or any special occasion, this stylish venue can cater for up to 75 people.

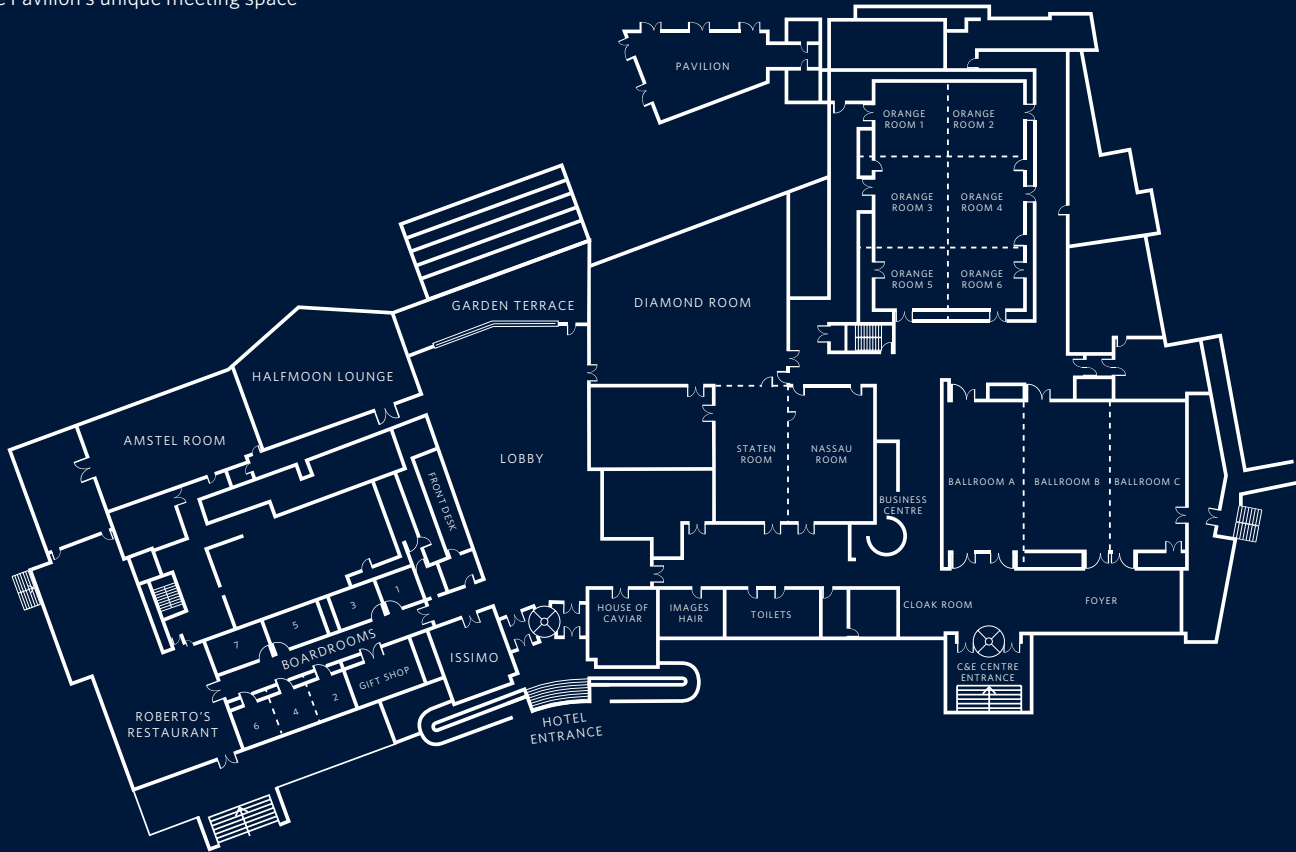

	Area (sqft)	Dimensions L x W x H (ft)	Classroom	Theatre	Banquet	Cabaret	Reception	Conference	U-Shape	H-Square
Amstel Room	1.350	27.92' x 50.83' x 10	60	130	100	80	150	36	30	40
Ballroom A	1.175	47.75' x 25.58' x 13	80	150	96	76	175	42	40	50
Ballroom A + B	2.397	47.75' x 51.83' x 13	160	300	192	172	350	54	60	70
Ballroom A + B + C	3.619	47.75' x 77.75' x 13	275	500	300	280	500	78	85	100
Ballroom B	1.175	47.75' x 25.92' x 13	80	150	96	76	175	42	40	50
Ballroom B + C	2.397	47.75' x 51.83' x 13	160	300	192	172	350	54	60	70
Ballroom C	1.175	47.75' x 25.58' x 13	80	150	96	76	175	42	40	50
Foyer	1.385	45.08' x 20.58'	—	—	—	—	300	20	—	—
Boardroom 1	120	10.67' x 12.33' x 8	—	—	—	—	—	4	—	—
Boardroom 2	132	11.83' x 12.83' x 9	—	—	—	—	—	6	—	—
Boardroom 2 + 4	275	11.83' x 25.83' x 9	—	—	—	—	—	12	—	—
Boardroom 2 + 4 + 6	429	11.83' x 39.33' x 8	—	—	—	—	—	18	—	—
Boardroom 3	150	10.67' x 15.33' x 9	—	—	—	—	—	6	—	—
Boardroom 4	132	11.83' x 12.83' x 9	—	—	—	—	—	6	—	—
Boardroom 4 + 6	286	11.83' x 26.25' x 8	—	—	—	—	—	12	—	—
Boardroom 5	180	10.67' x 18.83' x 9	—	—	—	—	—	6	—	—
Boardroom 6	143	11.83' x 13.08' x 9	—	—	—	—	—	6	—	—
Boardroom 7	170	10.67' x 17.83' x 9	—	—	—	—	—	6	—	—
Diamond Room	3.067	59.75' x 63.00' x 14	150	300	230	210	400	70	60	50
Nassau Room	902	41.67' x 22.33' x 14	50	90	60	40	100	40	30	40
Staten Room	903	43.00' x 21.33' x 14	50	90	60	40	100	40	30	40
Diamond + Staten	3.970	14 (h)	—	—	300	280	500	—	—	—
Diamond + Nassau + Staten	4.830	101.58' x 85.67' x 14	—	—	380	360	600	—	—	—
Nassau + Staten	1.763	41.67' x 43.92' x 14	100	180	140	120	200	45	50	50
Patio	905	43.83' x 21.00'	—	—	—	—	140	—	—	—
Orange Room 1	624	24.58' x 26.25' x 13	36	60	36	24	60	24	24	30
Orange Room 1-6	3.504	73.83' x 48.75' x 13	180	360	250	230	500	—	—	—
Orange Room 1 + 2	1.152	24.58' x 48.75' x 13	72	120	72	52	140	44	54	60
Orange Room 2	528	24.58' x 22.17' x 13	36	60	36	24	60	24	24	30
Orange Room 2 + 4 + 6	1.606	73.83' x 22.17' x 13	90	150	132	112	175	72	60	—
Orange Room 3	650	25.92' x 26.25' x 13	36	60	36	24	60	24	24	30
Orange Room 3 + 4	1.200	25.92' x 48.75' x 13	72	120	72	52	140	44	54	60
Orange Room 3 + 4 + 5 + 6	2.304	48.92' x 48.75' x 13	110	230	168	148	300	40	—	—
Orange Room 4	550	25.92' x 22.17' x 13	36	60	36	24	60	24	24	30
Orange Room 5	572	22.67' x 26.25' x 13	36	60	36	24	60	24	24	30
Orange Room 5 + 6	1.056	22.67' x 48.75' x 13	60	90	68	48	110	36	30	36
Orange Room 6	484	22.67' x 22.17' x 13	30	50	30	24	60	20	20	24
The Pavilion	753	27.50' x 39.83'	27	50	48	28	70	20	12	14

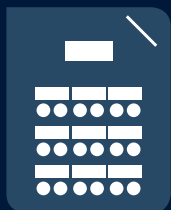

Classroom



Theatre

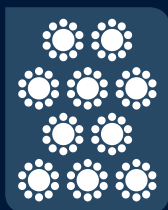

Banquet

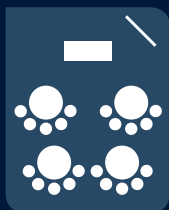

Cabaret

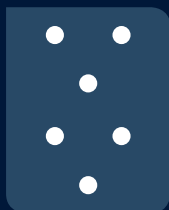

Reception

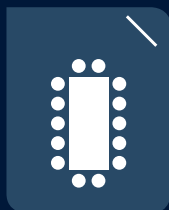

Conference

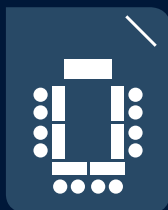

U-Shape



H-Square

